

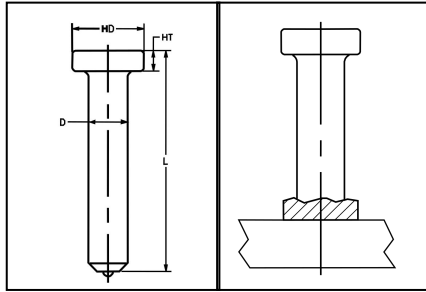

# TRU-FIT PRODUCTS • TRU-WELD

QUALITY WELD STUDS, STUD WELDING EQUIPMENT AND FASTENERS SINCE 1928

Atlanta • Calgary • Chicago • Dallas • Denver • Houston • Kansas City • Las Vegas • Medina • New York City • Salt Lake City • Smithville • Toronto • Vancouver



## HEADED CONCRETE ANCHOR – FULL WELD BASE

TYPE **CA** STUD  
TYPE F FERRULE SUPPLIED

Head Diameter (HD) – 1/2" for all 1/4" Headed Concrete Anchors.  
Head Height (HT) – 3/16" for all 1/4" Headed Concrete Anchors.

WELD STUD SPECIFICATIONS			WELD STUD PACKAGING			WELD STUD WEIGHTS		
D Diameter	L Length	TRU-WELD Part Number	Pieces Per Box	Boxes Per Pallet	Pieces Per Pallet	Box Weight	Pallet Weight	1,000 Piece Weight
1/4	1-1/8	CA04-018-12	2,000	27	54,000	47 lbs.	1,269 lbs.	22 lbs.
1/4	2-11/16	CA04-043-12	1,000	27	27,000	43 lbs.	1,161 lbs.	43 lbs.
1/4	3-1/8	CA04-050-12	1,000	27	27,000	49 lbs.	1,323 lbs.	49 lbs.
1/4	4-1/8	CA04-066-12	600	27	16,200	38 lbs.	1,026 lbs.	63 lbs.

**Concrete Anchors** are used in all types of concrete connections. They can be welded to a flat surface, or to the inside or outside of an angle.

**Length:** Length is listed before weld. Stud diameters 1/4" will be approx. 1/8" shorter after welding.

TRU-WELD concrete anchors can be made in any length above the standard minimum.

**Material:** Low carbon steel, ASTM A29 / A108, 1010-1020. CA Studs are also available in weldable stainless steel. Type 302 is the most commonly used. Other grades of stainless steel (except Type 303) are available when required.

Mechanical Property Requirements	
	Type B
Tensile Strength	65,000 psi Min
Yield Strength	51,000 psi Min
Elongation (% in 2 in.)	20% min.
Elongation (% in 5x dia.)	15% min.
Reduction of Area	50% min.

CHUCK PART #	FOOT PART #	GRIP PART #	FERRULE FOOT PLAT (DUAL LEG)
CN-050	B-1C	GC-025 (Standard Duty)	QN-025 (Standard Duty)
	B-1C	GC-037 (Heavy Duty)	QN-037 (Heavy Duty)

Type B Studs are headed, bent, or of other configuration that are used as an essential component in composite beam design and construction.