

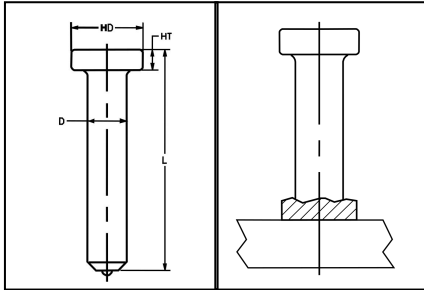

# TRU-FIT PRODUCTS • TRU-WELD

QUALITY WELD STUDS, STUD WELDING EQUIPMENT AND FASTENERS SINCE 1928

Atlanta • Calgary • Chicago • Dallas • Denver • Houston • Las Vegas • Medina • New York City • Salt Lake City • Smithville • Toronto • Vancouver



## SHEAR CONNECTOR – FULL WELD BASE

TYPE **SC** STUD  
TYPE **F** FERRULE SUPPLIED

Head Diameter (HD) – 1-3/8" for all 7/8" Shear Connectors.  
Head Height (HT) – 3/8" for all 7/8" Shear Connectors.

WELD STUD SPECIFICATIONS			WELD STUD PACKAGING			WELD STUD WEIGHTS		
D Diameter	L Length	TRU-WELD Part Number	Pieces Per Box	Boxes Per Pallet	Pieces Per Pallet	Box Weight	Pallet Weight	1,000 Piece Weight
7/8	3-3/16	SC14-051-11	100	27	2,700	66 lbs.	1,782 lbs.	631 lbs.
7/8	3-11/16	SC14-059-11	100	27	2,700	74 lbs.	1,998 lbs.	709 lbs.
7/8	4-3/16	SC14-067-11	75	27	2,025	60 lbs.	1,620 lbs.	796 lbs.
7/8	5-3/16	SC14-083-11	60	27	1,620	60 lbs.	1,620 lbs.	962 lbs.
7/8	6-3/16	SC14-099-11	50	27	1,350	58 lbs.	1,566 lbs.	1,137 lbs.
7/8	7-3/16	SC14-115-11	45	27	1,215	59 lbs.	1,593 lbs.	1,306 lbs.
7/8	8-3/16	SC14-131-11	40	27	1,080	59 lbs.	1,593 lbs.	1,496 lbs.
7/8	9-3/16	SC14-147-11	1,400	1	1,400	2,334 lbs.	2,334 lbs.	1,667 lbs.
7/8	10-3/16	SC14-163-11	1,000	1	1,000	1,800 lbs.	1,800 lbs.	1,800 lbs.
7/8	12-3/16	SC14-195-11	800	1	800	1,702 lbs.	1,702 lbs.	2,173 lbs.

**Shear Connectors** are used in all types of concrete connections. They can be welded to a flat surface, or to the inside or outside of an angle.

**Length:** Length is listed before weld. Stud diameters 7/8" will be approx. 3/16" shorter after weld.

TRU-WELD shear connectors can be made in any length above the standard minimum.

**Material:** Low carbon steel, (ASTM A108 / A29, AASHTO M169) 1010-1020. SC Studs are also available in weldable stainless steel. Type 302 is the most commonly used.

**\*\*Tru-Weld shear connectors are manufactured to conform to:**  
AWS D1.1, AWS D1.5, AWS D1.6, AASHTO, ISO-13918, CSA W59-2013. \*\*

See Also: ICC-ES Evaluation Report ESR-2577

### Mechanical Property Requirements

	Type B
Tensile Strength	65,000 psi min.
Yield Strength	51,000 psi min.
Elongation (% in 2 in.)	20% min.
Elongation (% in 5x d ia)	15% min.
Reduction of Area	50% min.

CHUCK PART #	FOOT PART #	GRIP PART #	FERRULE FOOT PLATE (DUAL LEG)
CH-087	B-3C	GC-087	QN-087

Type B Studs are headed, bent, or of other configuration that are used as an essential component in composite beam design and construction.