

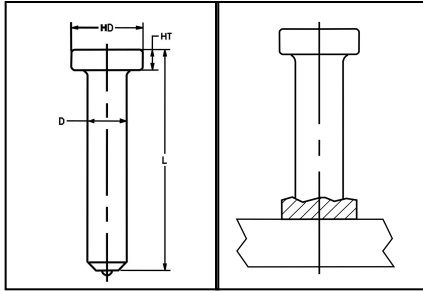

TRU-FIT PRODUCTS • TRU-WELD

QUALITY WELD STUDS, STUD WELDING EQUIPMENT AND FASTENERS SINCE 1928

Atlanta • Calgary • Chicago • Dallas • Denver • Houston • Las Vegas • Medina • New York City • Salt Lake City • Smithville • Toronto • Vancouver



HEADED CONCRETE ANCHOR – FULL WELD BASE

TYPE **CA** STUD

TYPE F FERRULE SUPPLIED

Head Diameter (HD) – 1" for all 1/2" Headed Concrete Anchors.

Head Height (HT) – 5/16" for all 1/2" Headed Concrete Anchors.

WELD STUD SPECIFICATIONS			WELD STUD PACKAGING			WELD STUD WEIGHTS		
D Diameter	L Length	TRU-WELD Part Number	Pieces Per Box	Boxes Per Pallet	Pieces Per Pallet	Box Weight	Pallet Weight	1,000 Piece Weight
1/2	1-1/8	CA08-018-12	600	27	16,200	68 lbs.	1,836 lbs.	112 lbs.
1/2	1-1/2	CA08-024-12	500	27	13,500	68 lbs.	1,836 lbs.	132 lbs.
1/2	1-5/8	CA08-026-12	450	27	12,150	63 lbs.	1,701 lbs.	140 lbs.
1/2	2-1/8	CA08-034-12	400	27	10,800	67 lbs.	1,809 lbs.	167 lbs.
1/2	2-5/8	CA08-042-12	350	27	9,450	68 lbs.	1,836 lbs.	194 lbs.
1/2	3-1/8	CA08-050-12	300	27	8,100	68 lbs.	1,836 lbs.	227 lbs.
1/2	4-1/8	CA08-066-12	200	27	5,400	56 lbs.	1,512 lbs.	280 lbs.
1/2	5-5/16	CA08-085-12	150	27	4,050	52 lbs.	1,404 lbs.	347 lbs.
1/2	6-1/8	CA08-098-12	125	27	3,375	50 lbs.	1,350 lbs.	400 lbs.
1/2	8-1/8	CA08-130-12	80	27	2,160	40 lbs.	1,080 lbs.	500 lbs.
1/2	10-1/8	CA08-162-12	150	9	1,350	91 lbs.	819 lbs.	606 lbs.
1/2	12-1/8	CA08-194-12	1,500	1	1,500	1,059 lbs.	1,059 lbs.	706 lbs.

Concrete Anchors are used in all types of concrete connections. They can be welded to a flat surface, or to the inside or outside of an angle.

Length: Length is listed before weld. Stud diameters 1/2" will be approx. 1/8" shorter after welding. TRU-WELD concrete anchors can be made in any length above the standard minimum.

Material: Low carbon steel, ASTM A29 / A108, 1010-1020. CA Studs are also available in weldable stainless steel. Type 302 is the most commonly used.

CHUCK PART #	FOOT PART #	GRIP PART #	FERRULE FOOT PLATE (DUAL LEG)
CH-050	B-1C	GC-050 (Standard Duty)	QN-050 (Standard Duty)
	B-2C	GC-062 (Heavy Duty)	QN-062 (Heavy Duty)

Mechanical Property Requirements

	Type B
Tensile Strength	65,000 psi min.
Yield Strength	51,000 psi min.
Elongation (% in 2 in.)	20% min.
Elongation (% in 5x dia.)	15% min.
Reduction of Area	50% min.

Type B Studs are headed, bent, or of other configuration that are used as an essential component in composite beam design and construction.