



TRU-WELD Stud Welding

SHEAR CONNECTOR – FULL WELD BASE

(3/4" THRU DECK SHEAR CONNECTORS ON NEXT PAGE)

TYPE **SC** STUD

TYPE F FERRULE SUPPLIED

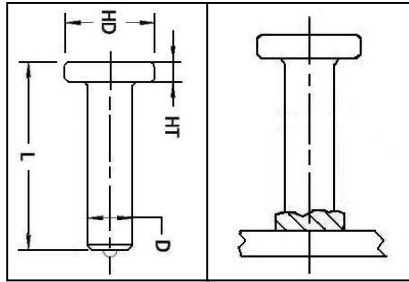

Head Diameter (HD) – 1-1/4" for all 3/4 headed Shear Connectors.
Head Height (HT) – 3/8" for all 3/4 headed Shear Connectors.

D Diameter	L Length	TRU-WELD Part Number	Pieces Per Box	Boxes Per Pallet	Pieces Per Pallet	Box Weight	Pallet Weight	1,000 Piece Weight
3/4	3-3/16	SC12-051-11	125	48	6,000	60 lbs.	2,880 lbs.	478 lbs.
3/4	3-11/16	SC12-059-11	100	48	4,800	55 lbs.	2,640 lbs.	548 lbs.
3/4	4-3/16	SC12-067-11	100	48	4,800	62 lbs.	2,976 lbs.	600 lbs.
3/4	4-11/16	SC12-075-11	75	48	3,600	51 lbs.	2,448 lbs.	672 lbs.
3/4	5-3/16	SC12-083-11	60	48	2,880	44 lbs.	2,112 lbs.	735 lbs.
3/4	5-11/16	SC12-091-11	60	48	2,880	48 lbs.	2,304 lbs.	797 lbs.
3/4	6-3/16	SC12-099-11	60	48	2,880	51 lbs.	2,448 lbs.	852 lbs.
3/4	6-11/16	SC12-107-11	70	27	1,890	64 lbs.	1,728 lbs.	905 lbs.
3/4	7-3/16	SC12-115-11	60	27	1,620	59 lbs.	1,593 lbs.	968 lbs.
3/4	8-3/16	SC12-131-11	50	27	1,350	56 lbs.	1,512 lbs.	1,105 lbs.
3/4	9-3/16	SC12-147-11	100	9	900	126 lbs.	1,134 lbs.	1,222 lbs.
3/4	10-3/16	SC12-163-11	100	9	900	137 lbs.	1,233 lbs.	1,339 lbs.
3/4	12-3/16	SC12-195-11	1,000	1	1,000	1,590 lbs.	1,590 lbs.	1,590 lbs.
3/4	16-3/16	SC12-259-11	700	1	700	1,457 lbs.	1,457 lbs.	2,081 lbs.

Shear Connectors are used in all types of concrete connections. They can be welded to a flat surface, or to the inside or outside of an angle.

Length: Length is listed before weld. Stud diameters 3/4" will be approx. 3/16" shorter after weld.

TRU-WELD shear connectors can be made in any length above the standard minimum.

Material: Low carbon steel, ASTM A29 / A108, 1010-1020. SC Studs are also available in weldable stainless steel. Type 302 is the most commonly used.

CHUCK PART #	FOOT PART #	GRIP PART #	FERRULE FOOT PLATE (DUAL LEG)
CH-075	B-2C	GC-075	QN-075

Mechanical Property Requirements

	Type A	Type B
Tensile Strength	61,000 psi min.	65,000 psi min.
Yield Strength	49,000 psi min.	51,000 psi min.
Elongation (% in 2 in.)	17% min.	20% min.
Elongation (% in 5x dia.)	14% min.	15% min.
Reduction of Area	50% min.	50% min.

Type A Studs are general purpose studs.

Type B Studs are headed, bent, or of other configuration that are used as an essential component in composite beam design

TFP Corporation/TRU-WELD
460 Lake Road
Medina, Ohio 44256

(330) 725-7741
(330) 725-0161 Fax
Sales@tfpcorp.com

<http://www.tfpcorp.com>
<http://www.truweldstudwelding.com>
<http://www.weldstud.com>